

9.2 Additional modules

9.2.1 Centring ring

The centring ring enables the assembly of the additional table top. It is provided with a fit of k6 so that the additional table top is usually manufactured with a centre hole with a fit of H7.

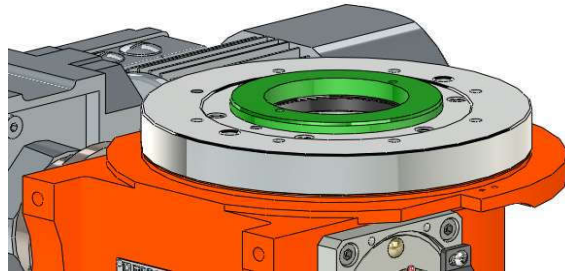

Fig.: Centring ring

9.2.2 Centring flange

For the mounting of the upper fixed table top, the standard flange can be replaced by a lifted centring flange. The height H5 can be changed as desired.

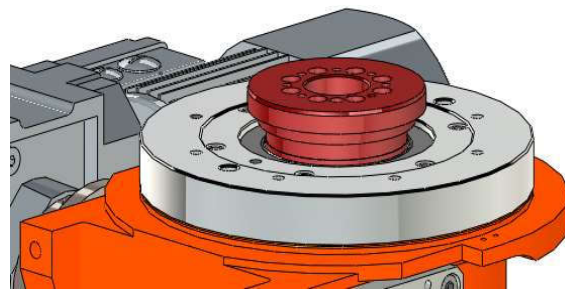

Fig.: Centring flange

9.2.3 Centring ring and centring flange

The centring ring and centring flange can be combined:

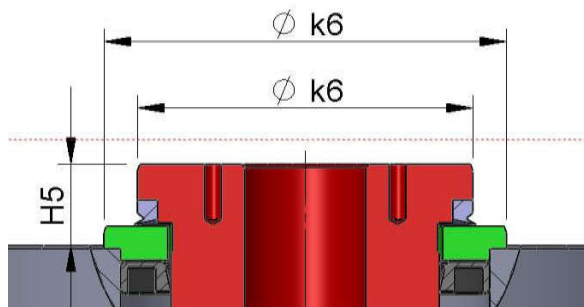

Fig.: Dimensioning of centring ring and centring flange

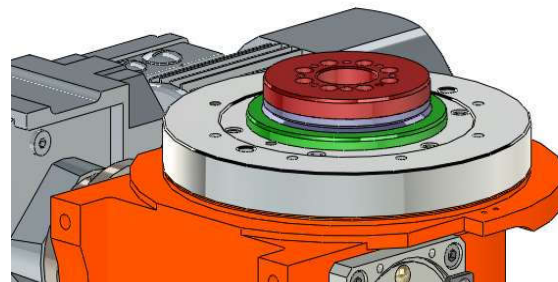

Fig.: Centring ring and centring flange